

- For planning purposes only  
 - Anyone scaling from this drawing is responsible to make sure that the graphic scale is accurate at a recognisable scale  
 - This drawing is copyright

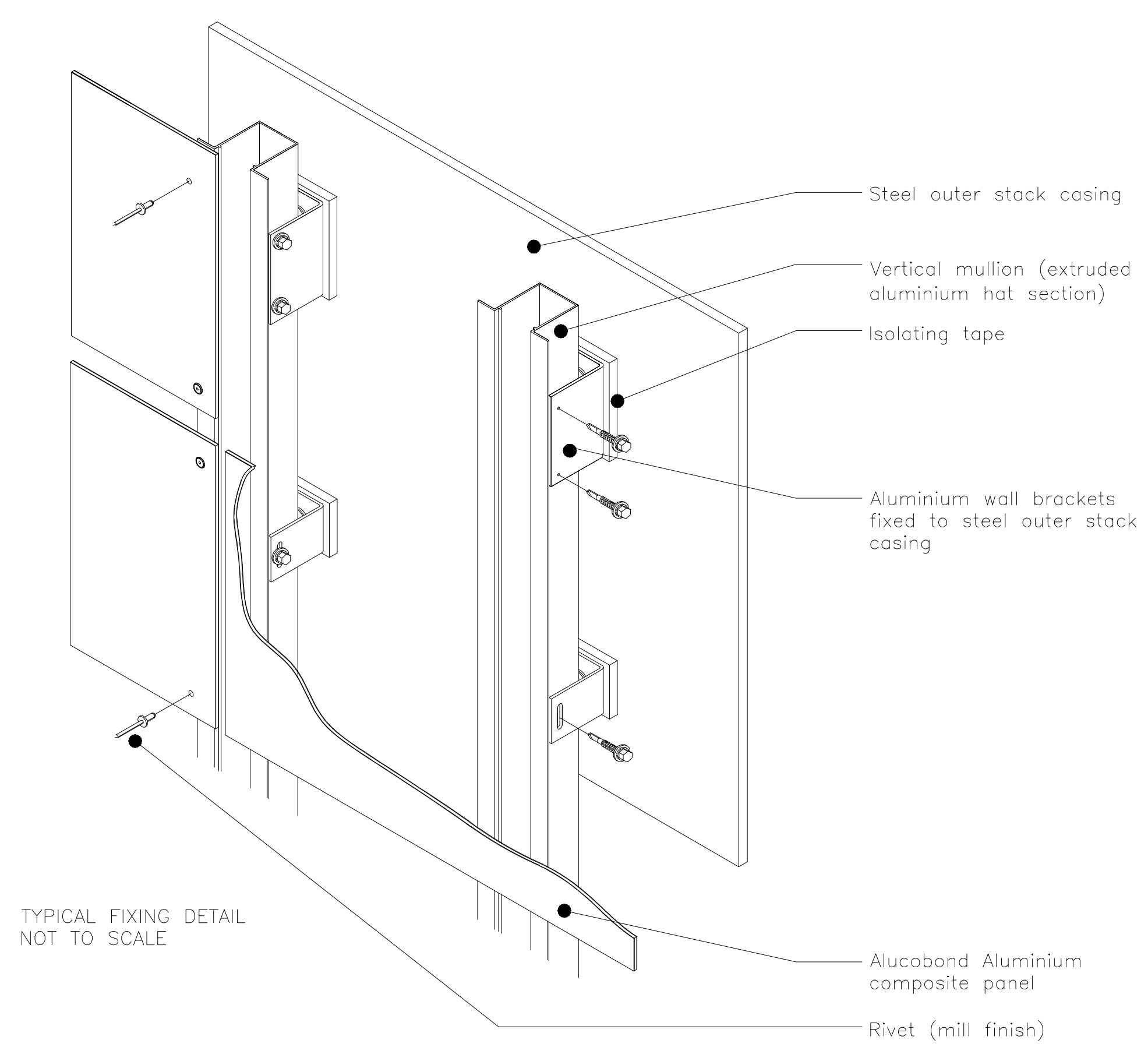

NOTE ON CLADDING MATERIAL MAINTENANCE:  
 The Alucobond Natural Reflect 405 cladding panel has a stove-lacquered surface, from which normal dirt and deposits are washed away by rainwater. Occasional cleaning is recommended by the manufacturer, depending on local environment conditions, and should be either manual using a soft brush or by means of a high-pressure cleaner with clean water. Cleaning will be programmed to coincide with scheduled maintenance of the CHP. Access to the panels would be from a self-propelled telescopic high reaching boom (cherry-picker) or other appropriate means such as cleaning basket suspended from mobile crane.

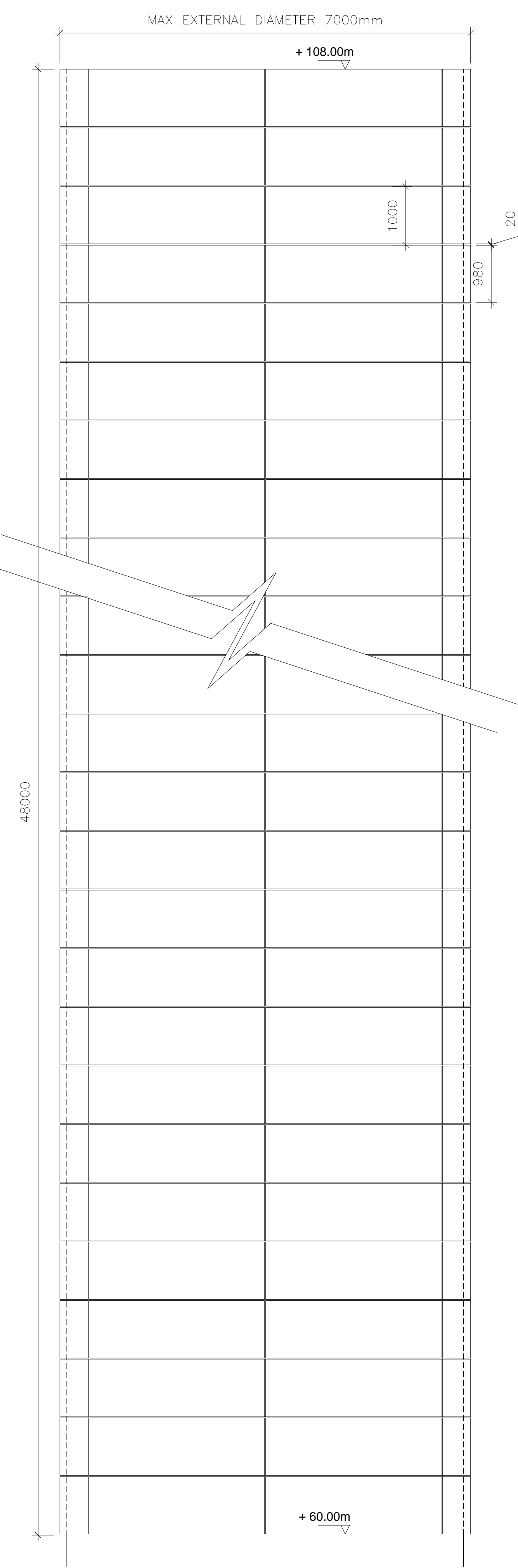
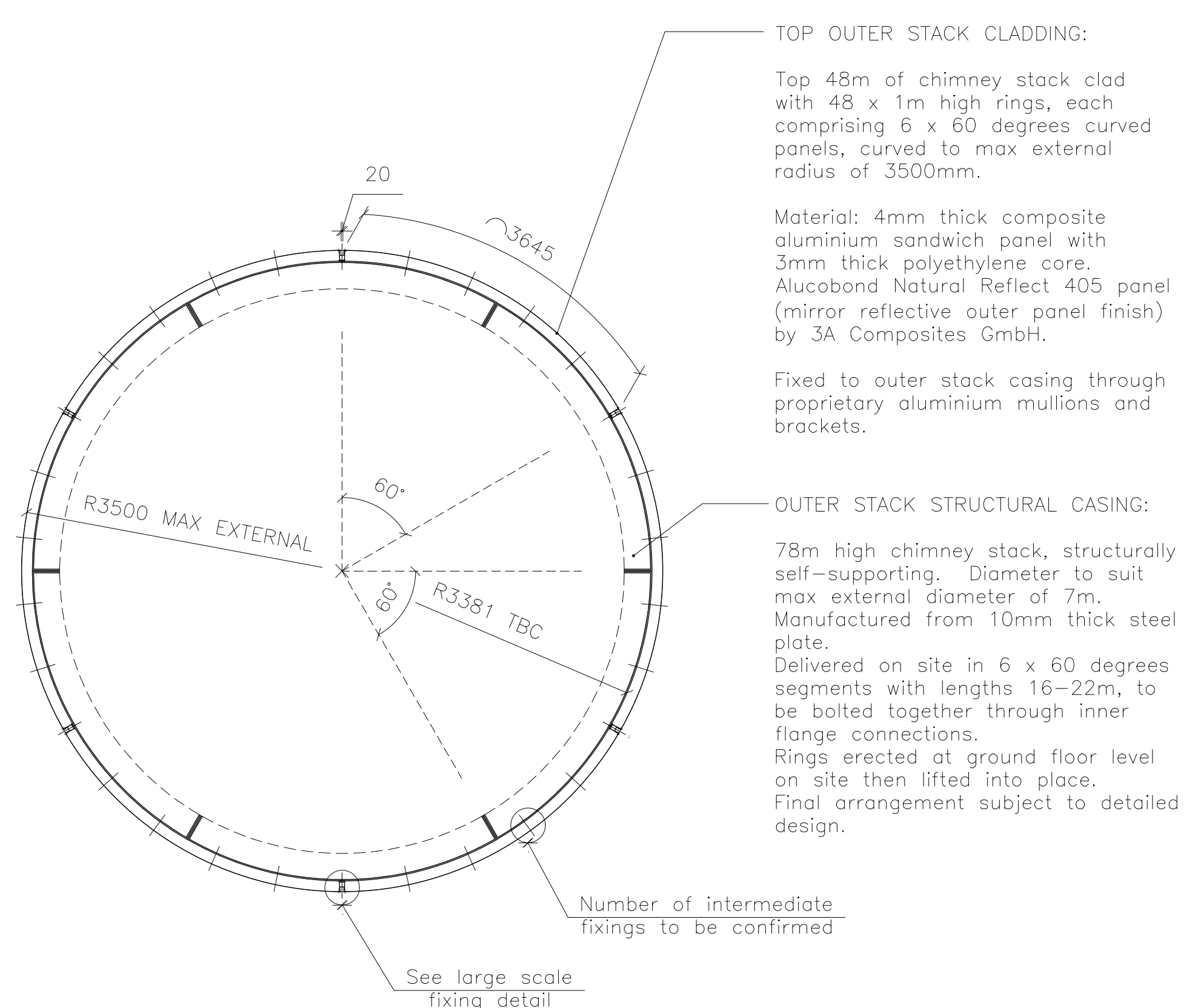
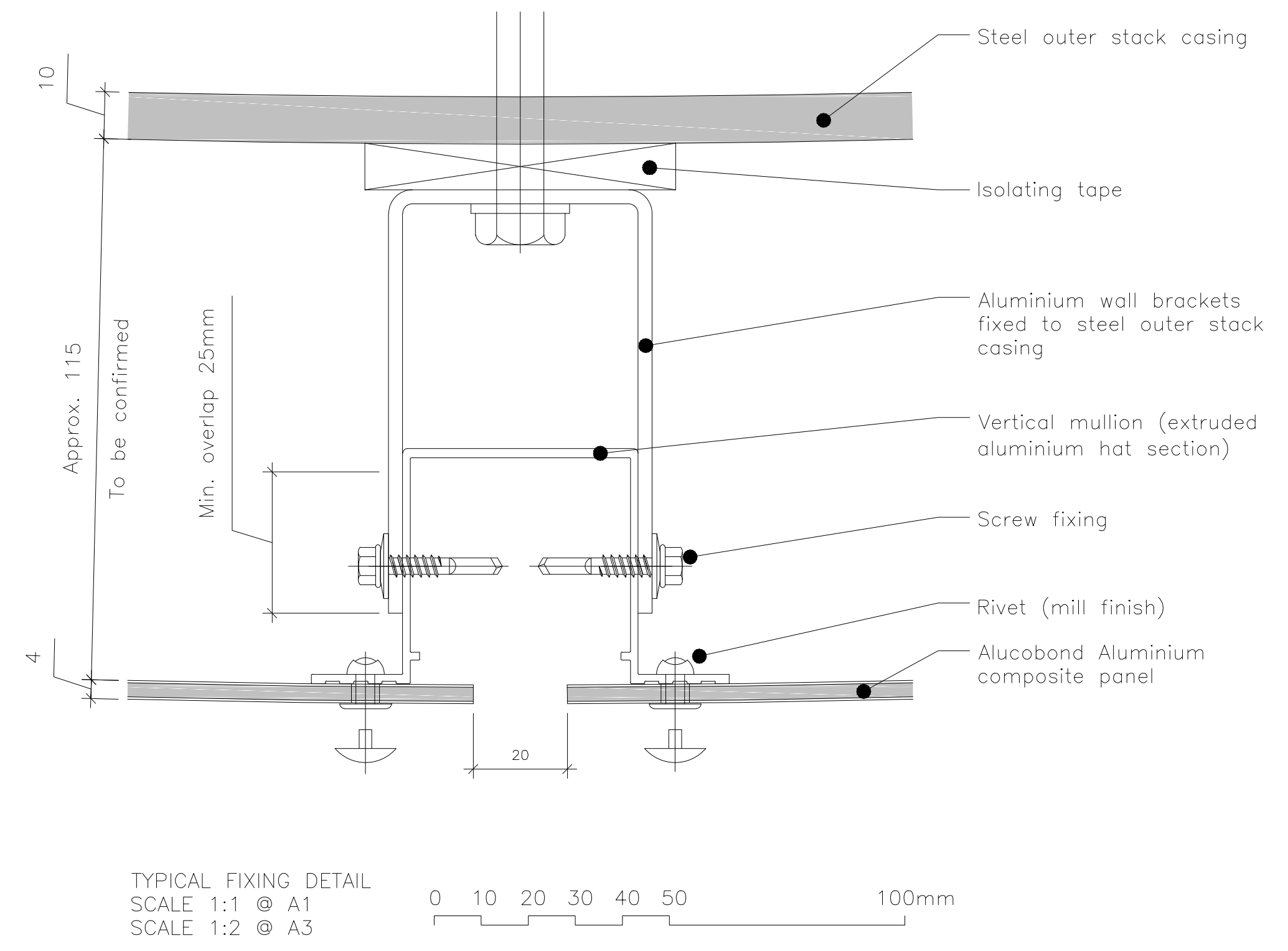

PLAN SCALE 1: 50 @ A1  
 SCALE 1:100 @ A3



PHOTOGRAPHS SHOWING THE ALUCOBOND CLADDING PANELS AT THE SCHONINGER SPEARS BUILDING (GERMANY) (Paläon, Schöninger Speere)

issue	date	drawn	notes	check
C	25.17	LRD	TOP OF STACK RAISED TO LEVEL +105.000	LRD
B	15.17	LRD	TOP OF STACK RAISED TO LEVEL +105.000	LRD
A	23.15	LRD	REVISED TO INCLUDE VARIOUS COMMENTS RECEIVED DURING A CHECK BY 2015	JF
ORIGINAL	17.15	LRD		JF

**ARCTICA**  
 ARCHITECTURE • PROCESS • COST & PROJECT MANAGEMENT  
 Telephone: 01780 482200 Fax: 01780 480716  
 freshthinking@arctica.co.uk

PROJECT  
**RIVENHALL IWMF**

DRAWING  
**CHIMNEY STACK TOP CLADDING DETAILS FIXING DETAILS**

AI SCALE	A3 SCALE	JOB
AS	NOTED	15-31
NUMBER		REV
LA02		C